

A-A 2:1 TYP 4 POSITIONS

VOLUME: 108142mm³

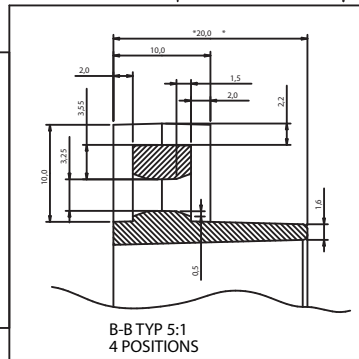

B-B TYP 5:1
4 POSITIONS

- MOLDING PROCESS NOTES
1. WRITTEN APPROVAL MUST BE OBTAINED FROM B&W FOR ANY NON CONFORMITY OF THE PART TO THIS DRAWING
 2. LOCATIONS OF GATE, EJECTORS & PARTING LINES TO BE APPROVED IN WRITING BY B&W PRIOR TO TOOLING
 3. ALL SURFACES TO BE FREE OF SINK MARKS, FLAKING OR ANY OTHER IMPERFECTIONS
 4. ALL SHARP EDGES CORNERS MUST MAX UNLESS STATED
 5. DIMENSIONS FOR POSITION ARE INDICATED BY "DIM"
 6. **DRAFT ANGLE 1.5° UNLESS STATED**
 7. PLEASE REFER TO TOLERANCE TABLE SHOWN BELOW
 8. STRAIGHT EDGES TO BE STRAIGHT OVER WHOLE LENGTH BY TOLERANCE 0.020 X EDGE LENGTH AND NOT EXCEED 0.2 OVER ANY 2.5 X DISTANCE
 9. FLAT SURFACES TO BE FLAT OVER WHOLE SURFACE BY 0.020 X LONGEST EDGE LENGTH AND NOT EXCEED 0.2 OVER ANY 2.5 X SECTION
 10. CIRCULAR OR PART CIRCULAR EDGES AND FACES TO BE ROUNDED TO TOLERANCE 0.020 X RADIUS AND NOT EXCEED 0.2 OVER ANY 2.5 X DISTANCE
 11. THE DRAWING NUMBER, DATE INDICATOR AND RECYCLE SYMBOL MUST BE ADDED TO THE TOOL IN POSITIONS AGREED BY B&W
 12. THIS 3-D DRAWING IS FOR CHECKING PURPOSES ONLY UNLESS STATED
 13. ALL NOTES APPLY UNLESS OTHERWISE STATED
 14. ALL UNDIMENSIONED 3-D FEATURES ARE SUBJECT TO THE RELEVANT PROCESS TOLERANCES SHOWN ABOVE
 15. ALL DIMENSIONS SHOWN ARE - DRAFT UNLESS OTHERWISE INDICATED

PLASTIC PROCESS TOLERANCES	
NOMINAL DIMENSION	TOLERANCE
TO 4 MAX	±0.1
4 TO 16 MAX	±0.2
16 TO 25 MAX	±0.3
25 TO 1000 MAX	±0.5
ANGLES	±0.5

ISSUE HISTORY		
ISS	ECR/SAN NUMBER	REQ
3		JG
DRN	DATE	CKD
RM	13.5.09	

ISSUE DETAILS:
FEASIBILITY UPDATES:
Ø3.0 EJECTOR BOSSES
ADDED;

ISS	ECR/SAN NUMBER	REQ
4	PDC3307	RL
DRN	DATE	CKD
RM	11.8.09	

ISSUE DETAILS:
8-OFF 32.0 WIDE CUT-OUTS
IN UPSTAND ADDED; 8-OFF
SETS OF 2.0 TYP RIBS
ADDED FOR DOG LANDING



MATERIAL	FINISH	TITLE
BLACK H.I.P.S	FREE OF MACHINING MARKS	CCM7 PMK FRAME

FIRST DRAWN BY	COPYRIGHT C O	DOC PART NO.
PAUL GOCHER	2009	
DATE	SCALE	DRG SIZE
7/4/09	1:1	A1

PART NO.	3-D DATA FILE NO.	2-D DRG. NO.
FF25342	A9829 -ISS- (3)	A9829-1-1

IF IN DOUBT ASK
ALL COMPONENTS MUST BE B&WS COMPLIANT

RECYCLE SYMBOL